

# 黄銅管(BsT)1

C2700T

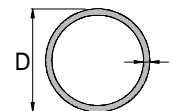

切断品も対応(別途ご相談)

調質:H

寸法 mm			1本の質量 (kg/本)	寸法 mm			1本の質量 (kg/本)	寸法 mm			1本の質量 (kg/本)
外径 D	肉厚 t	定尺長さ		外径 D	肉厚 t	定尺長さ		外径 D	肉厚 t	定尺長さ	
1.6	0.3	2,000	0.02	9.0	0.8	5,000	0.88	13.0	1.0	5,000	1.61
2.0	0.35	"	0.03		1.0	"	1.07		2.0	"	2.95
2.5	0.4	"	0.05		1.5	"	1.51	14.0	0.8	"	1.42
3.0	0.5	2,500	0.08	9.53	0.5	"	0.61		1.0	"	1.74
3.2	0.5	"	0.09		0.8	"	0.94		1.5	"	2.51
3.5	0.5	"	0.10		1.0	"	1.14		2.0	"	3.22
4.0	0.5	"	0.12		1.2	"	1.34	3.0	"	4.42	
	0.8	"	0.17		1.5	"	1.61	15.0	1.0	"	1.88
1.0	"	0.20	10.0	0.5	"	0.64	1.2		"	2.22	
4.5	0.5	"		0.13	0.8	"	0.99		1.5	"	2.71
5.0	0.5	"		0.15	1.0	"	1.21	2.0	"	3.48	
	0.8	5,000		0.45	1.2	"	1.42	15.9	0.5	"	1.03
	1.0	"		0.54	1.5	"	1.71		0.8	"	1.62
5.5	0.5	2,500	0.17	2.0	"	2.14	1.0		"	2.00	
6.0	0.5	5,000	0.37	11.0	0.5	"	0.70		1.2	"	2.36
	0.8	"	0.56		0.8	"	1.09		1.5	"	2.89
	1.0	"	0.67		1.0	"	1.34	2.0	"	3.73	
	1.2	"	0.77		1.5	"	1.91	3.0	"	5.19	
	1.5	"	0.90		2.0	"	2.41	16.0	1.5	"	2.72
6.4	0.5	"	0.40	12.0	0.5	"	0.77		2.0	"	3.75
	0.8	"	0.60		0.8	"	1.20	17.0	2.0	"	4.02
	1.0	"	0.72		1.0	"	1.47	18.0	1.0	"	2.28
7.0	0.5	"	0.44		1.2	"	1.74		1.5	"	3.32
	1.0	"	0.80		1.5	"	2.11		2.0	"	4.29
8.0	0.5	"	0.50	2.0	"	2.68	3.0	"	6.03		
	0.8	"	0.77	12.7	0.5	"	0.82	19.0	0.5	"	1.24
	1.0	"	0.94		0.8	"	1.28		0.8	"	1.95
	1.2	"	1.09		1.0	"	1.57		1.0	"	2.41
	1.5	"	1.31		1.2	"	1.85		1.2	"	2.86
	2.0	"	1.61		1.5	"	2.25		1.5	"	3.52
9.0	0.5	"	0.57		2.0	"	2.87		2.0	"	4.56

表記の質量はテーブル計算です。実際の商品は現物の実質量となります。重量を表示している規格は標準在庫品です。

# 黄銅管 (BsT) 2

C2700T

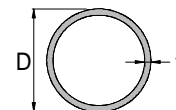

切断品も対応 (別途ご相談)

調質:H

寸法 mm			1本の質量 (kg/本)	寸法 mm			1本の質量 (kg/本)	寸法 mm			1本の質量 (kg/本)
外径 D	肉厚 t	定尺長さ		外径 D	肉厚 t	定尺長さ		外径 D	肉厚 t	定尺長さ	
19.0	3.0	5,000	6.43	27.0	1.0	5,000	3.49	32.0	2.0	5,000	8.04
20.0	1.0	"	2.55		3.5	"	11.20		34.0	1.5	"
	1.5	"	3.72	27.2	1.5	"	5.17	2.0		"	8.58
	2.0	"	4.82		3.0	"	9.73	3.0		"	12.46
	3.0	"	6.83	28.0	0.8	"	2.92	35.0	1.0	"	4.56
21.7	2.5	"	6.43		1.0	"	3.62		1.2	"	5.44
22.0	0.5	"	1.44		1.5	"	5.33		1.5	"	6.73
	0.8	"	2.27		2.0	"	6.97		2.0	"	8.84
	1.0	"	2.81		3.0	"	10.05		2.5	"	10.89
	1.2	"	3.34		4.0	"	12.86		3.0	"	12.86
	1.5	"	4.12		28.58	1.0	"		3.70	4.0	"
	2.0	"	5.36	1.5		"	5.44	5.0	"	20.10	
	3.0	"	7.64	2.0		"	7.12	36.0	1.5	"	6.93
4.0	"	9.65	3.0	"		10.28	3.0		"	13.27	
22.2	1.0	"	2.84	5.0	"	15.80	38.0	0.8	"	3.99	
24.0	2.0	"	5.90	30.0	1.0	"		3.89	1.0	"	4.96
25.0	1.0	"	3.22		1.5	"		5.73	1.2	"	5.92
	1.2	"	3.83		2.0	"		7.50	1.5	"	7.34
	1.5	"	4.73		2.5	"		9.22	2.0	"	9.65
	2.0	"	6.16		3.0	"		10.85	3.0	"	14.07
	2.5	"	7.54		4.0	"	13.94	5.0	"	22.11	
	3.0	"	8.84		5.0	"	16.75	40.0	1.0	"	5.23
25.4	0.5	"	1.67	31.8	0.8	"	3.32		1.5	"	7.74
	0.8	"	2.64		1.0	"	4.13		2.0	"	10.18
	1.0	"	3.27		1.2	"	4.92		3.0	"	14.87
	1.2	"	3.89		1.5	"	6.09		4.0	"	19.30
	1.5	"	4.80		2.0	"	7.99		5.0	"	23.45
	2.0	"	6.27		3.0	"	11.58	41.3	1.5	"	8.00
	2.5	"	7.67		4.0	"	14.90		3.0	"	15.40
	3.0	"	9.00		5.0	"	17.96	42.0	1.0	"	5.49
	5.0	"	13.67		32.0	1.5	"		6.13	2.0	"

表記の質量はテーブル計算です。実際の商品は現物の実質量となります。重量を表示している規格は標準在庫品です。

# 黄銅管 (BsT) 3

C2700T

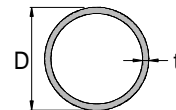

切断品も対応 (別途ご相談)

調質:H

寸法 mm			1本の質量 (kg/本)	寸法 mm			1本の質量 (kg/本)	寸法 mm			1本の質量 (kg/本)	
外径 D	肉厚 t	定尺長さ		外径 D	肉厚 t	定尺長さ		外径 D	肉厚 t	定尺長さ		
42.0	4.0	5,000	20.37	60.0	1.0	5,000	7.91	88.9	4.0	5,000	45.51	
42.7	1.5	"	8.28		1.5	"	11.76		5.0	"	56.21	
	2.0	"	10.91		2.0	"	15.54	95.0	3.0	"	36.98	
	3.0	"	15.96		3.0	"	22.91		5.0	"	60.30	
44.5	1.0	"	5.83		4.0	"	30.02	101.6	1.5	"	21.44	
	1.5	"	8.64		5.0	"	36.85		2.0	"	26.69	
	2.0	"	11.39		63.5	1.2	"		10.02	3.0	"	39.64
	3.0	"	16.68			1.5	"		12.46	4.0	"	52.31
	5.0	"	26.47			2.0	"		16.48	5.0	"	64.72
45.0	5.0	"	26.80			3.0	"		24.32	6.0	"	76.86
46.0	3.0	"	17.29	4.0		"	31.89		108.0	3.0	"	42.21
48.0	1.5	"	9.35	5.0		"	39.20		110.0	5.0	"	70.35
	5.0	"	28.81	65.0		3.0	"		24.92	114.3	3.0	"
48.6	1.5	"	9.47			5.0	"		40.20		5.0	"
	2.0	"	12.49	70.0		2.0	"	18.22	120.0	3.0	"	47.03
	3.0	"	18.33			3.0	"	26.93		5.0	"	77.05
50.0	1.5	"	9.75		5.0	"	43.55	127.0	3.0	"	49.85	
	2.0	"	12.86	75.0	3.0	"	28.94		5.0	"	81.74	
	3.0	"	18.89		5.0	"	46.90	130.0	5.0	"	83.75	
	4.0	"	24.66		1.5	"	15.02	135.0	5.0	"	87.10	
	5.0	"	30.15	2.0	"	19.89	140.0	5.0	"	90.45		
50.8	1.0	"	6.67	76.2	3.0	"	29.43	150.0	3.0	"	59.09	
	1.2	"	7.98		4.0	"	38.70		5.0	"	97.15	
	1.5	"	9.91		5.0	"	47.70	152.4	5.0	"	98.76	
	2.0	"	13.08	80.0	3.0	"	30.95	160.0	5.0	"	103.85	
	3.0	"	19.22		5.0	"	50.25	165.0	5.0	"	107.20	
	4.0	"	25.08	82.5	3.0	"	31.96	180.0	5.0	"	117.25	
	5.0	"	30.69		5.0	"	51.93	200.0	5.0	"	130.65	
55.0	3.0	"	20.90	88.9	1.5	"	17.57					
	5.0	"	33.50		2.0	"	23.29					
57.0	3.0	"	21.71		3.0	"	34.54					

表記の質量はテーブル計算です。実際の商品は現物の実質量となります。重量を表示している規格は標準在庫品です。