

アルミ丸棒 (1)

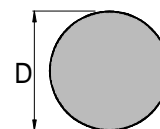

● 在庫品

直径 D mm	材 質						定尺長さ mm	A1070 1mの質量 (Kg/m)
	A1070 (1S)	A2017-T4 (17S)	A5052 (52S)	A5056 (56S)	A6061 T6 (61S)	C6PT8 (A2011) (11S相当)		
3	●		●				2,000	0.019
4	●		●				"	0.034
5	●	●	●			●	"	0.053
6	●	●	●			●	"	0.076
7	●	●	●			●	"	0.104
8	●	●	●	● _{L=4000}		●	"	0.136
9	●	●	●			●	"	0.175
10	●	●	●	●	●	● _{L=2000}	4,000	0.212
11	●	●	●			● _{L=2000}	"	0.257
12	●	●	●	●		● _{L=2000}	"	0.307
13	●	●	●	●			"	0.359
14	●	●	●	●		● _{L=2000}	"	0.417
15	●	●	●	●		● _{L=2000}	"	0.478
16	●	●	●	●	●	● _{L=2000}	"	0.549
17	●	●	●	●			"	0.615
18	●	●	●	●			"	0.690
19	●	●	●	●	●		"	0.768
20	●	●	●	●	●		"	0.852
21		●					"	0.939
22	●	●	●	●			"	1.030
23		●					"	1.126
24		●					"	1.226
25	●	●	●	●	●		"	1.330
26	●	●	●	●			"	1.438
28	●	●	●	●			"	1.669
30	●	●	●	●	●		"	1.916
32	●	●	●	●	●		"	2.180
33		●					"	2.371
34		●					"	2.461
35	●	●	●	●	●		"	2.608
36	●	●	●	●			"	2.800
38	●	●	●	●			"	3.104
40	●	●	●	●	●		"	3.406
42	●	●	●	●	●		"	3.754
45	●	●	●	●	●		"	4.310
46		●					"	4.501
48		●	●	●	●		"	4.901
50	●	●	●	●	●		"	5.321

表記の質量はテーブル質量です。実際の商品とは異なる場合があります

アルミ丸棒 (2)

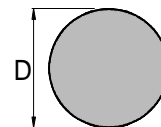

● 在庫品

直径 D mm	材 質						定尺長さ mm	A1070 1mの質量 (Kg/m)
	A1070 (1S)	A2017-T4 (17S)	A5052 (52S)	A5056 (56S)	A6061 T6 (61S)	C6PT8 (A2011) (11S相当)		
52		●					4,000	5.753
55	●	●	●	●	●		"	6.438
60	●	●	●	●	●		"	7.719
65	●	●	●	●	●		"	9.056
70	●	●L=4000	●	●	●		2,000	10.506
75	●	●L=4000	●	●	●		"	12.061
80	●	●L=4000	●	●	●		"	13.722
85	●	●L=4000	●	●	●		"	15.377
90	●	●L=4000	●	●	●		"	17.241
95	●	●L=4000	●	●	●		"	19.205
100	●	●L=4000	●	●	●		"	21.284
105		●					"	23.550
110	●	●	●	●	●		"	25.754
115		●					"	28.013
120	●	●	●	●	●		"	30.649
130	●	●	●	●	●		"	35.963
140	●	●	●	●	●		"	41.650
150	●	●	●	●	●		"	47.800
160	●	●	●	●	●		"	54.900
170		●	●	●	●		"	61.480
180		●	●	●	●		"	69.000
190		●	●	●	●		"	76.800
200		●	●	●	●		"	85.200
210		●		●	●		"	93.820
220		●		●	●		"	103.00
230		●		●	●		"	112.60
240		●		●	●		"	122.60
250		●		●	●		"	133.00
260		●		●	●		"	143.80
270		●		●	●		"	156.70
280		●		●	●		"	166.90
290		●		●			"	178.70
300		●		●	●		"	191.60
310		●		●			"	204.50
320		●		●			"	217.90
330		●		●			"	231.70
340		●		●			"	246.00
350		●		●			"	260.70

表記の質量はテーブル質量です。実際の商品とは異なる場合があります